



Part Number 75-109-4 Softail Rocker 2:1 Competition Series Exhaust System (08-09)

Congratulations, you have purchased the finest exhaust system available for your motorcycle. Your Vance & Hines Motorsports exhaust is designed and crafted for maximum performance, a great sound and unbeatable style. Please follow the instructions below, check exhaust system for missing or damaged parts and if you need any assistance please contact our technical support line (317) 852-9057.

STOCK EXHAUST SYSTEM REMOVAL

Please remove the following:

1. Under the oil tank on the right hand side, locate the rear O² sensor connector. Unplug sensor and feed the end of wire through the frame. Note: Pay attention to wire routing for reinstallation.
2. Open the plastic cover above the rectifier located at the front of the frame. This will give you access to the front O² sensor connector. Unplug the sensor connector. Remove the cable tie holding the wire to the frame.
3. Loosen the heat shield clamps on both front and rear exhaust pipes.
4. Remove the nuts from both front and rear exhaust cylinder head flanges.
5. Remove the nuts attaching the exhaust mounting bracket to the frame.
6. Remove the entire exhaust system and set it aside.
7. Using a 7/8" or 22mm wrench, carefully remove the O² sensor from the stock head pipes and save for re-use with the new system.
8. Remove the stock exhaust flanges and circlips from both the front and rear head pipes.
9. Remove the studs that held the exhaust too to the frame as they will not be used.
10. If the circlips are bent or damaged we recommend replacing them.

We recommend replacing the stock exhaust gaskets with the Screamin Eagle gasket kit, part number # 17048-98.

COMPETITION SERIES EXHAUST SYSTEM INSTALLATION

1. Identify front head pipe #7-80282. Install the stock flange and circlip, install head pipe leaving the flange nuts hand tight.
2. Repeat the above step for the rear head pipe #7-80283.
3. Slip the megaphone assembly onto the head pipes, secure with the springs supplied using the spring puller tool.
4. Align the megaphone mounting bracket to the frame and secure with the two 3/8" x 3/4 bolts supplied.
5. Tighten the cylinder head flange nuts and bolts for both the front and rear head pipes.
6. Replace the O² plugs with the O² sensors removed from the stock exhaust on the front and rear head pipes.
7. Reconnect the O² sensors to the wire harness.
8. Clean all fingerprints from the exhaust using a contact cleaner (or other non flammable cleaner). Fingerprints will leave stains on the pipe once the motorcycle is started.
9. You are now ready to start the motorcycle.

Note: After initial ride it is recommended to re-torque the baffle screw to 8-10 lb. using a 5/32" allen wrench.

For best results, we recommend fuel injection mapping for your new combination using a Fuelpak or Power Commander. Settings for the Fuelpak and some Power Commander maps are available on our website at www.vhmotorsports.com

Vance & Hines Motorsports

1211 Northfield Drive, Brownsburg, IN 46112

Tel: (317) 852-9057 Fax: (317) 852-8954

E-mail: tech@vhmotorsports.com

Web: www.vhmotorsports.com

Opening Hours – Monday through Friday, 8am – 5pm, Eastern Standard Time

Due to the nature of high performance racing products and services, Vance & Hines Motorsports products are sold without any express warranty or any implied warranty of fitness for a specific purpose. Vance & Hines Motorsports shall not, under any circumstances, be liable for any special, incidental or consequential damages including, but not limited to, damage or loss which may arise from sale, installation or use of this product.

75-109-4 HD ROCKER 2:1 COMPETITION SERIES EXHAUST SYSTEM (08-09)



75-109-4 PARTS LIST		75-109-4 /QTY.
PART NO.	DESCRIPTION	
7-50070	Meg./Baffle Assy.	1
7-80282	Front Pipe Assy.	1
7-80283	Rear Pipe Assy.	1
7-70007	O ² Sensor Plug	2
7-30002	Spring	2
7-70044	Flange Bolt, 3/8-16 x 3/4	2
7-60032	Comp. Series Baffle Assy. 10 1/2" TVD-DPD	1
7-70014	Bolt, BHCS 1/4"-20 x 5/8"	1
7-70058	Bolt, BHCS 1/4"-20 x 1/2"	1
7-70055	Flat Washer	2
7-70056	Lock Washer	2
7-70036	Rivet	2
7-50044	Name Plate 2.5" CL	1
7-30004	Exhaust Spring Puller Tool	1
7-60007	Baffle Packing	1

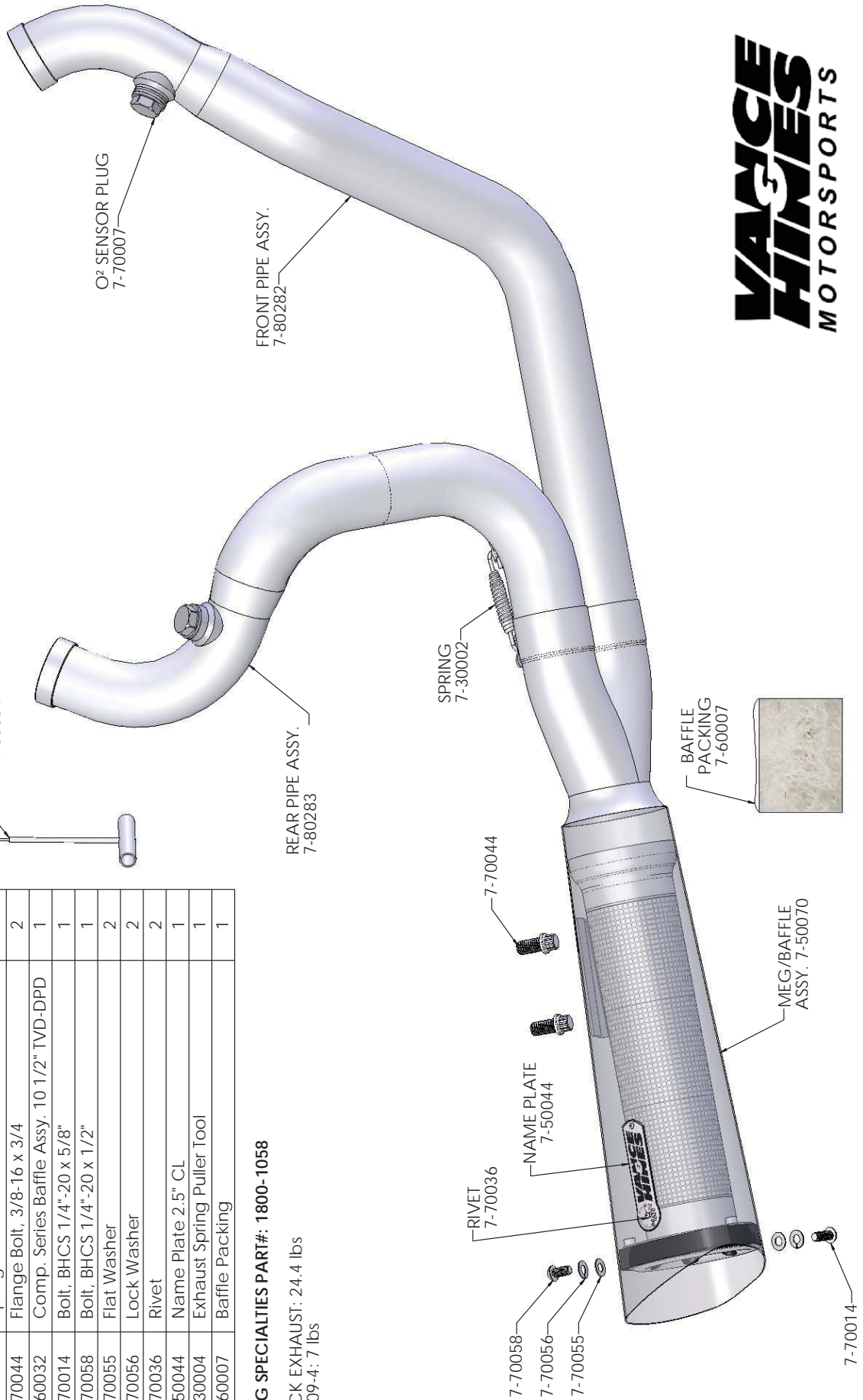

DRAG SPECIALTIES PART#: 1800-1058

STOCK EXHAUST: 24.4 lbs

75-109-4: 7 lbs