

Part Number 75-110-4
V-Rod Muscle 2:1 Competition Series
Exhaust System (09)

Congratulations, you have purchased the finest exhaust system available for your motorcycle. Your Vance & Hines Motorsports exhaust is designed and crafted for maximum performance, a great sound and unbeatable style. Please follow the instructions below, check exhaust system for missing or damaged parts and if you need any assistance please contact our technical support line (317) 852-9057.

ATTENTION:

This exhaust system is for racing purposes only. Must use early model #65109-01 exhaust gaskets and not the Muscle #64971-09 exhaust gaskets.

STOCK EXHAUST SYSTEM REMOVAL

Please remove the following:

1. To remove the stock mufflers loosen and remove the two nuts holding the muffler to the passenger foot-peg. Remove foot-peg and stud assembly from the rubber grommets and set aside. Loosen and remove the single nut towards rear of the muffler which holds the muffler to the round bar section of the foot-peg/exhaust bracket. Loosen the muffler clamp that holds the muffler to the head pipe. Loosen all heat shield clamps and remove heat shields from pipes. Pull muffler away from head pipe and set aside. Repeat for both sides.
2. Remove Foot-peg/exhaust bracket by removing the three allen bolts holding the bracket to the frame, set bracket aside. Repeat for both sides.
3. Remove rear pipe by removing the three allen screws that hold on the pulley/belt cover to gain access to exhaust flange nuts. Loosen and remove the two exhaust flange nuts. Loosen the crossover pipe clamp. Disconnect the O² sensor wire by following the wire to the connector underneath the seat. Unplug the connector and pull wire free from all clamps. Remove pipe and set aside. If using a Power Commander install O² eliminators now.
4. Disconnect front O² sensor plug by removing the allen screw on bottom of the left side radiator cowl, pull downward at the bottom of the cowl to free from pin and then lift at the top of the cowl to free from another pin, set cowl aside.
Note: Do not use excessive force on the cowl panel or damage may result.
5. Remove front cylinder pipe by loosening exhaust flange nuts. Carefully remove pipe from bike. If using a Power Commander install O² eliminators now and reinstall cowl panel.
6. Remove the passenger peg from the original mounts using a snapping pliers, be careful to not overexpand the circlip.
7. Carefully remove the stock exhaust flanges and circlips from the front and rear head pipes.

If the exhaust circlips are bent or twisted they should be replaced, Harley-Davidson part number #65045-01
Replace the stock exhaust gaskets with Harley-Davidson part number #65109-01

COMPETITION SERIES EXHAUST SYSTEM INSTALLATION

1. Locate left foot-peg mount (with spacer) #7-70069 install using one M8 x 25mm socket head cap screw and a M8 x 50mm socket head cap screw supplied. Use a medium strength loctite® and torque to 18 ft/lbs refer to (Figure 1), repeat for the right side refer to (Figure 2).
2. Reinstall the original passenger pegs removed earlier on to the new foot-peg mounts.
3. Identify front head pipe #7-80310. Install the stock flange and circlip, install head pipe leaving the flange nuts hand tight.
4. Repeat the above step for the rear head pipe #7-80311.
5. Install megaphone mounting bracket #7-70074 (with grommet) to the megaphone with two 5/16 flange bolts and dog bone nut plate supplied. First slide the dog bone nut plate inside the bracket welded to the back of the megaphone then attach and align bracket refer to (Figure 2), leave the bolts hand tight at this time.
6. Slip the megaphone/collector assembly onto the head pipes. Align megaphone mounting bracket refer to (Figure 2) install using the remaining M8 x 25mm socket head cap screw and a flat washer on each side of the grommet use a medium strength loctite® and torque to 18 ft/lbs.
7. Rotate the exhaust so there is adequate clearance in all places. Clearance at the clutch cover should be at least 1/4".



Figure 1



Figure 2



Figure 3



Figure 4

8. Tighten the cylinder head flange nuts for both the front and rear head pipes. Tighten the two 5/16 flange bolts supporting the megaphone mounting bracket.
9. If using a Power Commander with O² eliminators tighten the O² plugs on the front and rear head pipes.
10. If using a fuel management system that requires the stock O² sensors remove them from the stock head pipes and reinstall, refer to (Figure 3) for front cylinder and (Figure 4) for rear cylinder wire routing.
11. Make sure the oil line is not touching the front head pipe. If necessary, loosen the ties and rotate the oil line away from head pipe, retie the oil line to the fan mount.
12. Clean all fingerprints from the exhaust using a contact cleaner (or other non flammable cleaner). Fingerprints will leave stains on the pipe once the motorcycle is started.
13. You are now ready to start the motorcycle.

Note: After initial ride it is recommended to re-torque the baffle screw to 8-10 lb. using a 5/32" allen wrench and retighten the cylinder head flange nuts.

For best results, we recommend fuel injection mapping for your new combination using a Fuelpak or Power Commander. Settings for the Fuelpak and some Power Commander maps are available on our website at www.vhmotorsports.com

Vance & Hines Motorsports
1211 Northfield Drive, Brownsburg, IN 46112
Tel: (317) 852-9057 Fax: (317) 852-8954
E-mail: tech@vhmotorsports.com
Web: www.vhmotorsports.com
Opening Hours – Monday through Friday, 8am – 5pm, Eastern Standard Time

Due to the nature of high performance racing products and services, Vance & Hines Motorsports products are sold without any express warranty or any implied warranty of fitness for a specific purpose. Vance & Hines Motorsports shall not, under any circumstances, be liable for any special, incidental or consequential damages including, but not limited to, damage or loss which may arise from sale, installation or use of this product.

75-110-4 PARTS LIST		75-110-4 /QTY.
PartNo	DESCRIPTION	
7-50073	Megaphone/Baffle Assy.	1
7-80310	Front Pipe Assy.	1
7-80311	Rear Pipe Assy.	1
7-70007	O ₂ Sensor Plug	2
7-30002	Spring	2
7-70046	Bolt, Flange Serrated 5/16-18 x 3/4	2
7-70036	Rivet	2
7-50044	Name Plate	1
7-60032	Comp. Series Baffle Assy. 10 1/2"	1
7-70043	Dog Bone Nut Plate	1
7-70073	Exhaust Mount Isolator Spacer	1
7-70074	Megaphone Mount	1
7-70075	Rubber Grommet MS	1
7-70076	Washer, 5/16x13/16x.055 Thk	2
7-70077	Bolt, M8x1.25x25mm	1
7-70069	Muscle Lt Footpeg Mnt Assy. BPC	1
7-70068	Muscle Rt Footpeg Mnt Assy. BPC	1
7-30004	Exhaust Spring Puller Tool	1

75-110-4 V-ROD MUSCLE 2:1 COMPETITION SERIES EXHAUST SYSTEM (09)

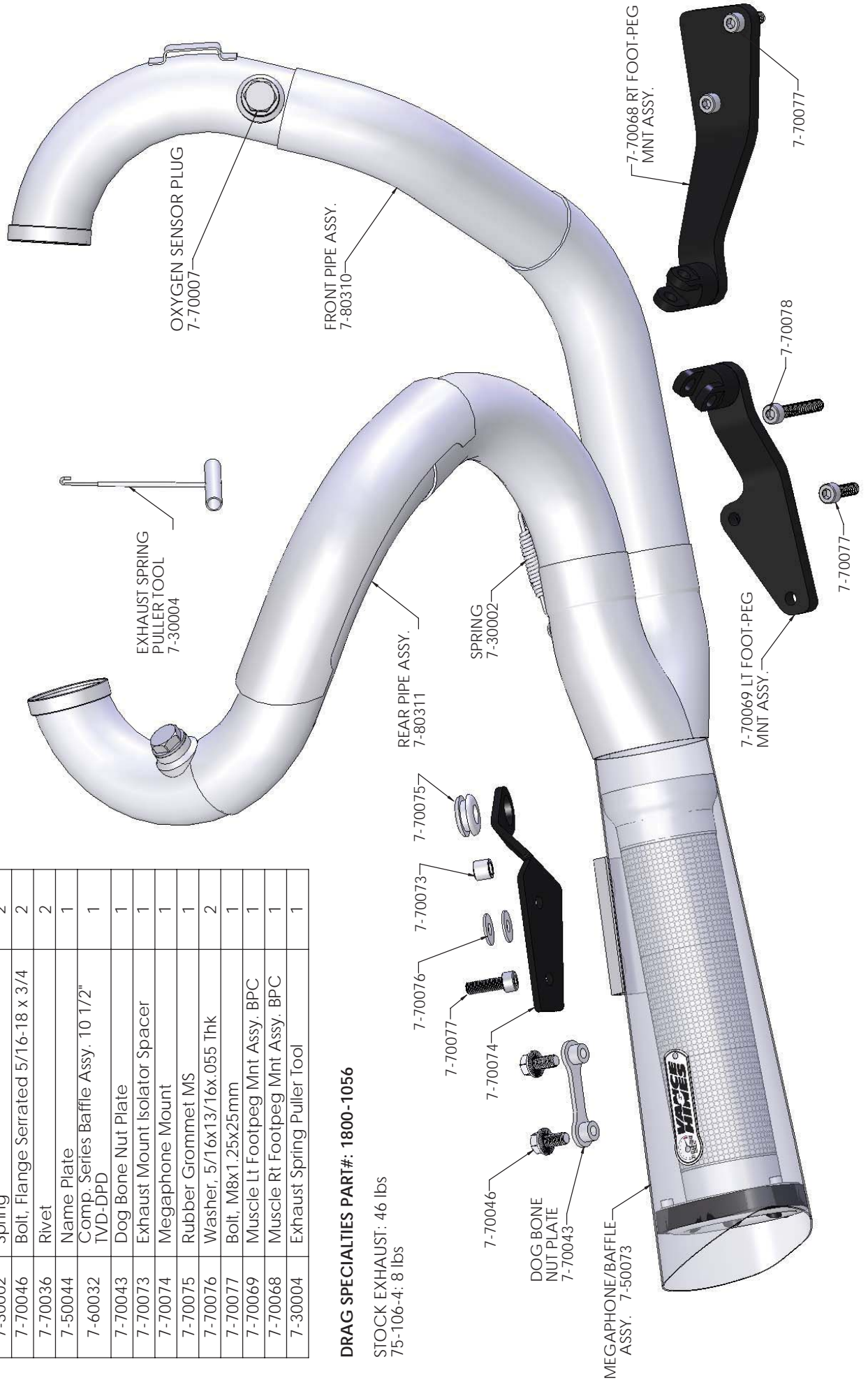

DRAG SPECIALTIES PART#: 1800-1056

STOCK EXHAUST: 46 lbs
75-106-4: 8 lbs